

**PLAN SHOWING:
PROPOSED PORTIONS 4055 - 4072
BALLITOVILLE
SITUATE IN THE KWADUKUZA MUNICIPALITY
REGISTRATION DIVISION FU
PROVINCE OF KWAZULU - NATAL**

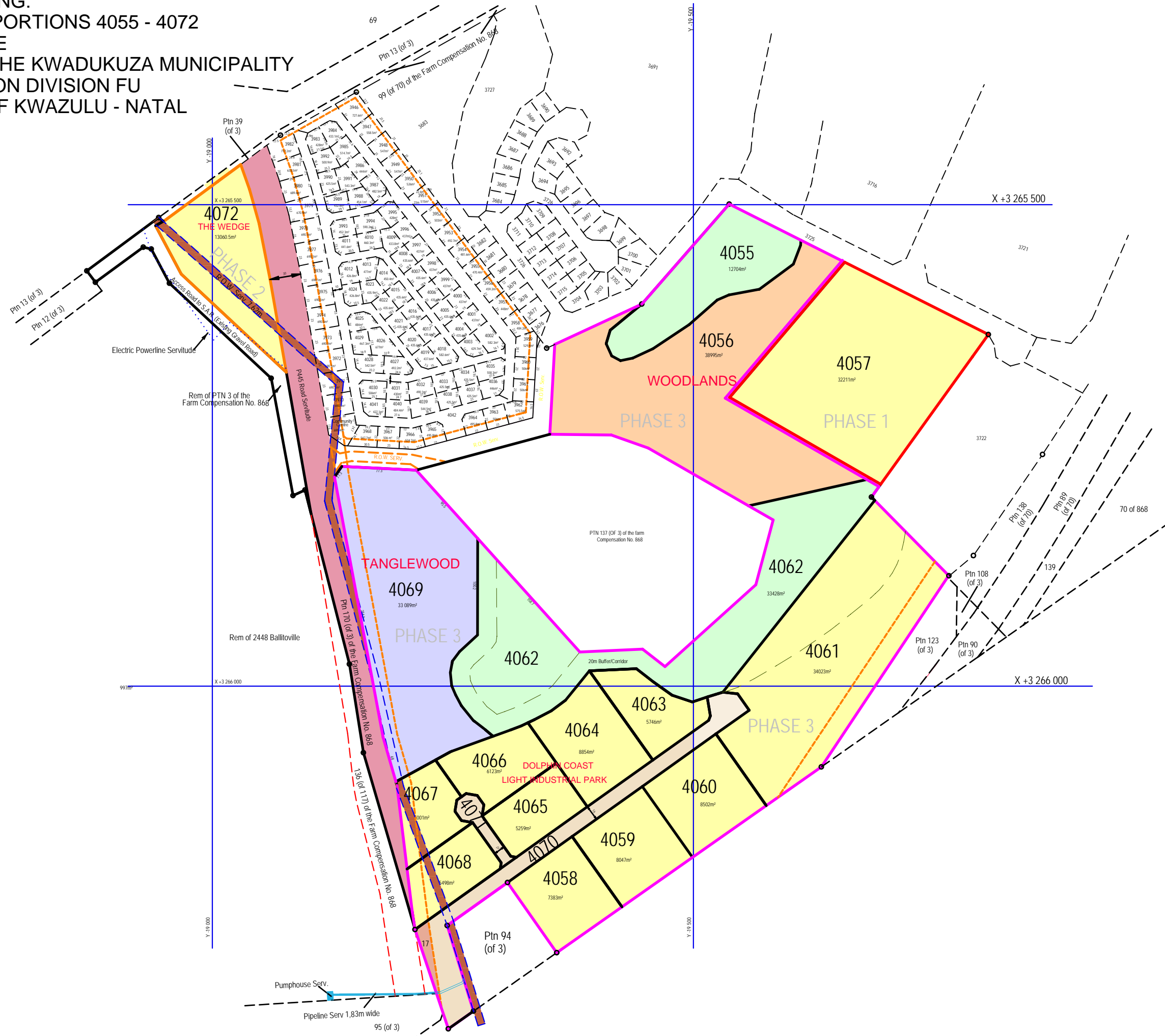

PLAN SHOWING:

LEGEND:

| Land Use | Erven | Area (m ²) |
|--------------------------|-----------|-----------------------------|
| Group Housing | 1 | 33 088.9m ² |
| Activity Zone | 12 | 139 721m ² |
| Intermediate Residential | 1 | 38 995 m ² |
| Private Open Space | 2 | 44 208 m ² |
| Private Roads | 1 | 11 487.1m ² |
| Provincial Road (M445) | N/a | - |
| Total | 17 | 267 500m² |

CLIENT:
BLUE MOONLIGHT PROPERTIES (PTY) LTD

- NOTES:
1. Areas and Dimensions are approximate and subject to final survey
 2. Proposed Erf 4055, 4062, 4070 & 4071 to be transferred to the Home Owners Association.
 3. Contour Interval = 1m
 4. Restrictive conditions in the title deed will be removed.
 5. Portion 178 (of 3) of the farm Compensation No. 868 to be redesignated to Erf 4054 Ballitoville.
 6. Portion 179 (of 3) of the farm Compensation No. 868 to be redesignated to Erf 4072 Ballitoville.

Phasing:
The development is to be undertaken in three phases as shown.

PROJECT TITLE:
Harmony Estates

DRAWING TITLE:
Layout Plan

| | |
|-------------------------|---------------------|
| K2M Technogen (Pty) Ltd | |
| 33 Mvini Road | PostNet Suite 509 |
| Kloof | Private Bag x 4 |
| 3610 | Kloof |
| | 3690 |
| | Tel: 031 - 764 6743 |
| | Fax: 031 - 764 2354 |

| | | | |
|-------------|------------------------|-------|-----------|
| DESIGNED | GW | SCALE | 1:4000 |
| DRAWN | GW | DATE | July 2008 |
| DRAWING No: | VHM 2008-07-L01 Rev 00 | | |